



radical
innovation
in hospitality
award

2011

Honorable Mention

Mediance

Submitted By:

Delstanche – Poland

Raphael Delstanche



Mediance Hotel

An aerial photograph of a tropical beach with clear turquoise water and a small island in the distance. In the foreground, four computer mice are placed on the sand, arranged in a loose pattern. The sky is blue with scattered white clouds.

A mission driven environmental hotel

"Between me and myself
there is the Earth." J.M. Besse



Mediance Hotel

Mediance Hotel is responsible hospitality to endangered, disappearing, threatened places due to climate change.

The Intergovernmental Panel on Climate Change (IPCC) provides regular reports on the scientific, technical and socio-economic information relevant for the understanding of human induced climate change, potential impacts of climate change and options for mitigation and adaptation. Since we often fail to consider change until we see — and deeply, emotionally feel — just what's at stake. Based on IPCC reports, Mediance Hotel is an initiative to allow tourists to experience the impact of global warming first hand, provide those visitors with opportunities, understand the causes and consequences of climate change, eventually exchange knowledge and share initiatives, raise awareness and stimulate action from personal day-to-day habits to political activism, and to help preserve the precious beauty of this world we live in.

Mediance Hotel invites you to an immersion in beauty of the most resonant kind.



Core principles

Climate Change Endangered Area Focus

Focus on giving visitors the opportunity to personally and directly witness threatened places while avoiding threatening them further.

Interpretation

Provide opportunities to experience endangered places in ways that lead to greater understanding, raise awareness and advocacy.

Environmental Sustainability Practice

Represent best practice for environmentally sustainable tourism.

Contribution to Conservation

Positively contributes directly to the conservation of natural areas.

Benefiting Local Communities

Provides constructive ongoing contributions to the local community.

Cultural Respect

Being sensitive to, interpreting and involving the local culture(s).

Customer Satisfaction

Consistently meets consumer expectations.

Responsible Marketing

Be marketed and promoted honestly and accurately so that realistic expectations are formed.

Eco-lodge

Mediance has been designed with reference to the eco-lodge model.

Comprising some 10-15 temporarily 'mPods' around a communal lodge. Each Pod is essentially a 1-bedroom apartment with attached en-suite and tea/coffee making facilities. All other amenities reception, lounge, restaurant, a thematic library on climate threats specific to each of the place and bar are located in the communal area. It's form has been derived from a combination of several factors. These include the creation of an extremely low-impact facility, extensive use of passive solar design and wind energy, use of lightweight materials with easy assembling, as well as the wish to give clients a contemporary facility that provides security against the elements. The end result is a universally transportable pod that have the ability to be replicated and situated in almost any environment. The ultra-modern and striking appearance is also intended to make a strong statement to emphasize an important part of the mission: raising awareness. mPod comes in 2 sizes: 100% for the living pods and 150% oversized for the communal areas pods.

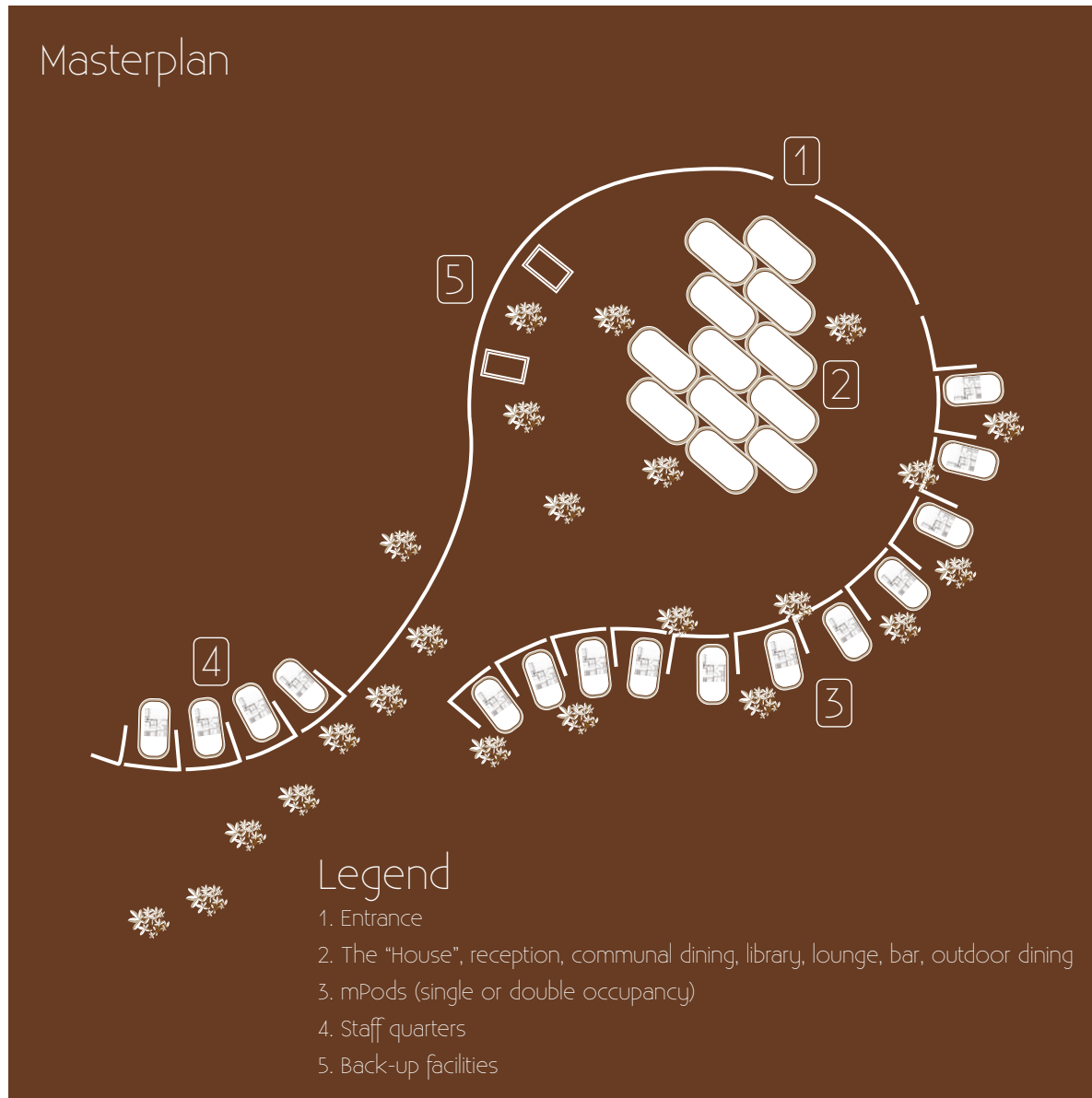

Rising temperatures

Mount Kilimanjaro, Tanzania | The Amazon Rainforest, Brazil | Borneo, Indonesia |
Lake Baikal, Siberia, Russia | Zackenberg, Greenland | Kauai, Hawaii, USA | ...



The damage of corals

The Great Barrier Reef, Australia | Mergui Archipelago, Myanmar |
Komodo Island, Indonesia | Ontong Java Atoll, Solomon Islands | Vavatu, Tonga |
Tuvalu, The Pacific Ocean | ...



The melting of sea ice

Valdes Peninsula, Argentina | The Antarctic Peninsula, Antarctica | Western Hudson Bay, Canada | The Bering Sea, Russia & USA | Nunavut, Canada | Ilulissat Icefjord, Greenland | ...



Less Precipitation

Greater Blue Mountains, NSW, Australia | County Meath, republic of Ireland | Lake Balaton, Hungary | Amman, Jordan | Cherrapunji, india | Perth, Australia | ...



Rising sea levels

Venice Italia | The battery NYC, USA | The Mississippi River Delta, USA | Recife, Brazil |
The Maldives, The Indian Ocean | The Ganges Delta, Bangladesh | ...



Extreme weather events

Honduras, | Trinidad, Cuba | The Panama Canal , Panama |
Caracas, Venezuela | Gujarat, India | ...



Melting of Glaciers

Sagarmatha National Park, Himalaya, Nepal | Kitzbuhel, The Alps, Austria | Chacaltaya, Bolivia | Quelccaya Ice Cap, Peru | Tian Shan, Kazakhstan | ...



mPods

Touching the Earth lightly

The aboriginal proverb, “touch the earth lightly” is a fundamental principle of our project development. The mPod defines an unusual architectural pre-requisite: a sense of non-permanence, off grid and harmonic with nature at the gateway of endangered places. The mPod is a sophisticated high-tech boutique encampment built with scrupulous attention to environmental impact. To avoid harming even further the threatened places, which could take years to recover, the mPods are prefabricated in pieces and assembled leaving the place as pristine as it could be after construction and is easily removable from the landscape with minimal impact or permanent damage to the site. Depending on locations the Camp comprises 10 to 15 pods. The walkways are suspended on stilts to reduce floor disturbances. Roads and services have the least possible impact on the site, with all services (telephones, sewage, power and drainage) being incorporated into suspended bridges, walkways or ducked into roadways.

Vehicular access to sites will be minimized as far as possible, with centralized parking and minimum road widths. This approach ensures that we don't impose ourselves on nature, don't stand above it and certainly don't stand apart from it. Instead we immerse our guests, in the awe-inspiring environments, that expresses a relationship between humans and the earth based on custodianship, sensitivity and respect. That results in developments that have the least possible impact (both visually and physically) on the natural & cultural landscape, and reflects both internally and externally, the “sense of place” evoked by the intrinsic qualities of the landscape. We believe our concept strives to reflect and add value to the essential natural attributes of the landscape. The natural landscapes are in effect “flowing” through and over the structures. We applied passive design principles to allow for maximum use of natural light and ventilation to reduce energy requirements. A unique chameleoning effect facilitate the structures to blend, almost disappearing, into the natural environment. We are using materials that enhance “lightness” and “non-permanence” of structures, without compromising the need to ensure structural competency, comfort and function or cost effectiveness. With their dematerializing qualities the mPod is not competing with, nor detract, the cultural or aesthetic value of the site.

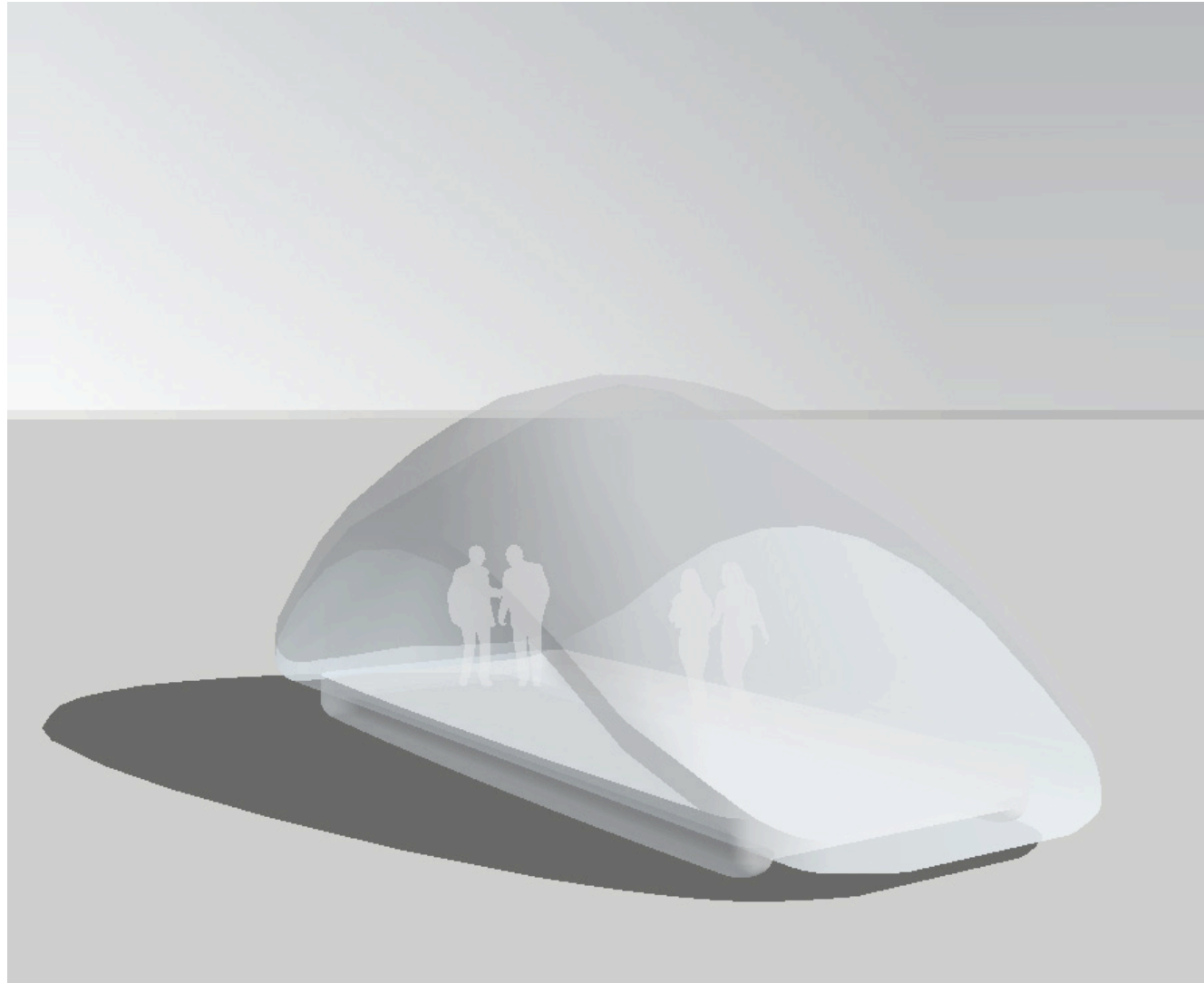

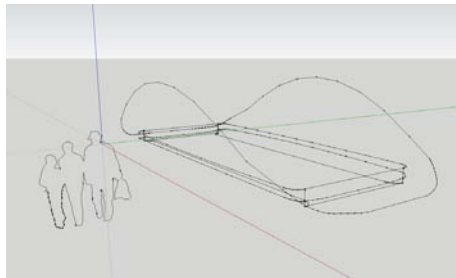
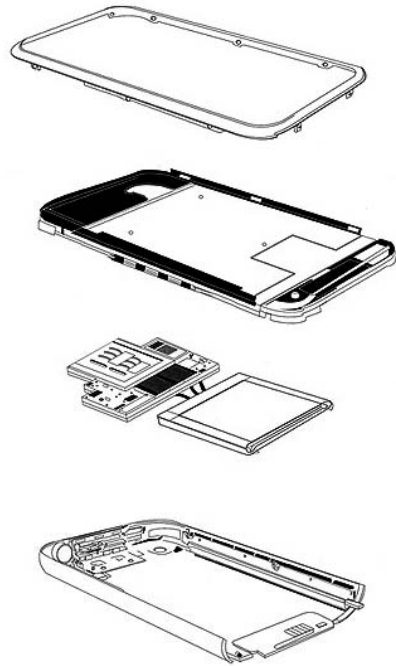
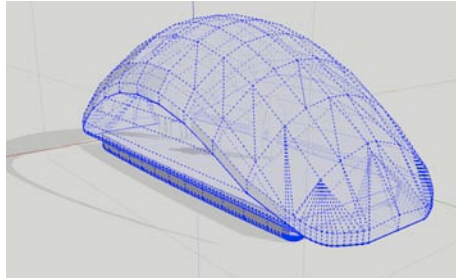

A living unit

High-tech

The mPod is in principle a self-sufficient living unit, defined by 3 main elements.

Firstly, an external intelligent electrochromic envelope, solar flexible material and clear acrylic mirror coated external finish, but see-through from inside. Secondly, a smart floor containing all technical components, such as solar batteries, water tanks, sewage and hydraulic system. And thirdly, a central prefab module, the wellness center, ready to plug in to the smart floor that contains a bathroom, a toilet and a mini kitchen.

Explained in depth, the outer shell is made from a new unique technology: a flexible electrochromic foil device with sufficient optical modulation range, dynamics, and durability for practical uses. The device incorporates a film of W oxide made by sputtering in the presence of hydrogen, another film of Ni-V oxide made by sputtering and post deposition treatment in ozone, and a polymer laminate. By using a multilayer-structure comprising several different materials between two plastic films, one creates a flexible and light-weight electrochromic foil capable of changing its degree of darkness when an electrical voltage of a few volts is applied. The voltage drives ions from a layer of nickel oxide, via a polymer electrolyte, into a layer of tungsten oxide. Both of the oxide layers then become darker. Reversing the polarity makes the ions move in the opposite direction, and the two layers brighten. The mPod occupants will be able to see outside under every lighting condition, daytime and night time without being seen if they wish. An electronic control unit makes it possible to regulate the degree of darkness of the electrochromic foil. The regulation can be manual or automatic; for example, through connection to a sensor network. When the desired degree of darkness has been achieved, the optical properties are kept until the next change is effected (in about the same way as an electric battery maintains its charge over a long time). So the foil does not use electricity except when its degree of darkness is being altered. This makes the foil very energy efficient in comparison with other technologies for regulating transparency. More advanced technologies offers a remarkable opportunity to extract energy from renewable energy sources both wind and solar to achieve its energy needs. The combination of two technologies, VAWT and mPods integrated system that relies on photovoltaic panels, ensures that almost in every weather condition the mPod -de facto mini power plants- will generate a sufficient energy output..

Configuration

Accommodation

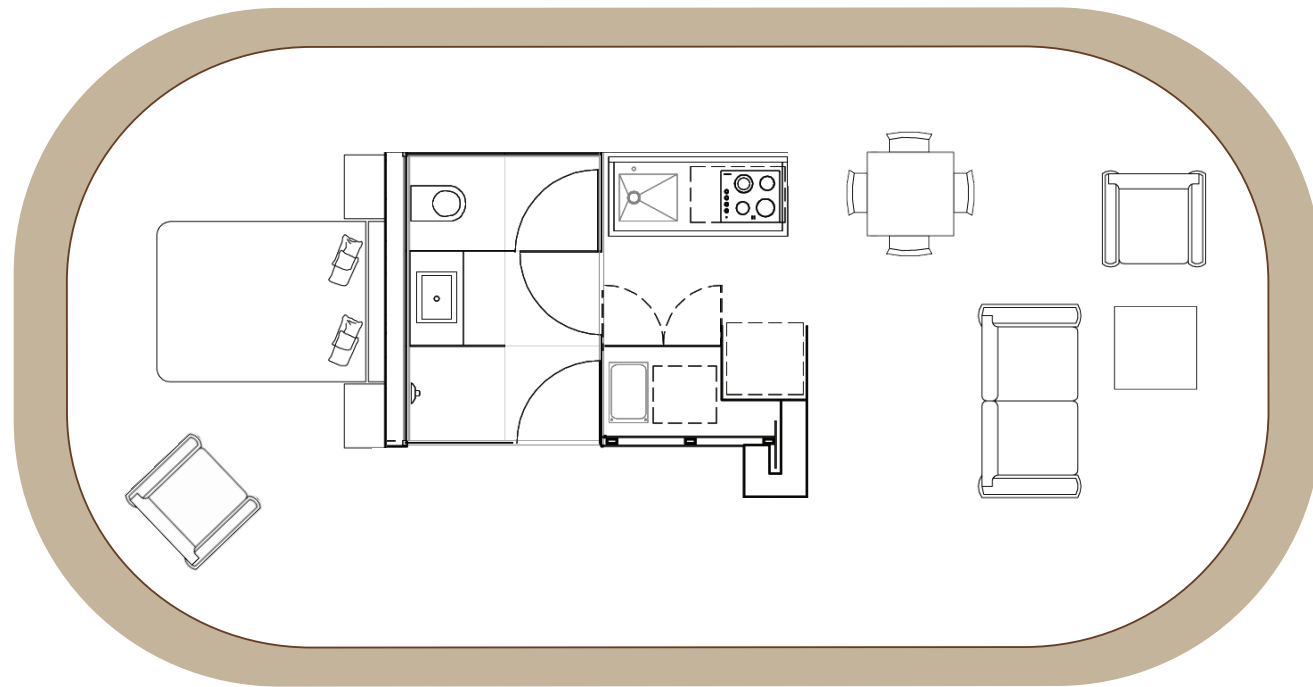

The mPod provides a high standard of accommodation for two people plus two.

The essential characteristics are immediately apparent. The wall-less structure opens the interior to its natural surroundings to an extreme degree. This distinctly expressed envelope, which forms the roof and the floor, induce an open space for living. The mPod is slightly elevated above the ground by eight adaptable feet. The mPod seems to float weightlessly above the ground it occupies. The original opening system, acts as a transition between the living area and the ground.

The mPod uses a concept of an unobstructed space that is flexible for use by people. The interior appears to be a single open room, its space ebbing and flowing around an element housing a wardrobe cabinet, mini-kitchen, bathroom and toilet. The larger living area core seems like a separate house nesting within the larger mPod. The structure is essentially one large hotel room filled with freestanding elements that provide subtle differentiations within an open space, implied but not dictated, zones for sleeping, cooking, showering, dressing, eating, sitting, contemplating and even meditating. Very private areas such as toilets, and mechanical rooms are enclosed within the core.

The notion of a single room that can be freely used or zoned in any way, with flexibility to accommodate changing uses, free of interior supports, enclosed in an envelope (a placenta) and supported by a minimum of structural framing, is the architectural ideal that defines the mPod.

mPod comes in 2 sizes: 100% for the living pods and 150% oversized for the communal areas pods for a larger comfort and that are designed to be assembled together and allow fluid communication to one another.



Expression

Inside and Outside

The mPod addresses basic issues about the relationship between the individual and his environment and acts as a catalyst to exist in harmony with the environment to successfully fulfill himself. A tool to help reconcile the individual spirit with the environment.

Reconnecting the individual with nature is one of the great challenges of an urbanized society.

Mediance Hotel offers an opportunity to bring man's relationship to nature into the forefront, highlights the individual's connection to nature through the medium of a man-made shelter, an attempt to bring nature, the shelter and the human being to a higher unity. Ultimately this is an indoor-outdoor architectural shelter simultaneously independent of and intertwined with the domain of nature.

Mediance

"A human milieu implies not only to the ecological, but also technical and symbolic relations; it is an eco-techno-symbolic entity (e.g. implying language), which necessarily completes the individual body in the structural moment of human existence, or **mediance**.

This structural moment produces the specific world of a certain culture (or of a certain person within that culture), a process which is called cosmophany, or the manifestation of certain world. Cosmophany is not specific to humankind, since each living species (including the human) possesses its own milieu, or Umwelt in Uexküll's terms. Milieu is specifically produced by a living species through the interpretation of its environment (Umgebung), in the process of evolution. Yet only human milieux are historical, since they include technical and symbolic relationships which multiply the reflexivity of the milieu, thus generating secondary cosmophanies of the basic human cosmophany".

A. Berque

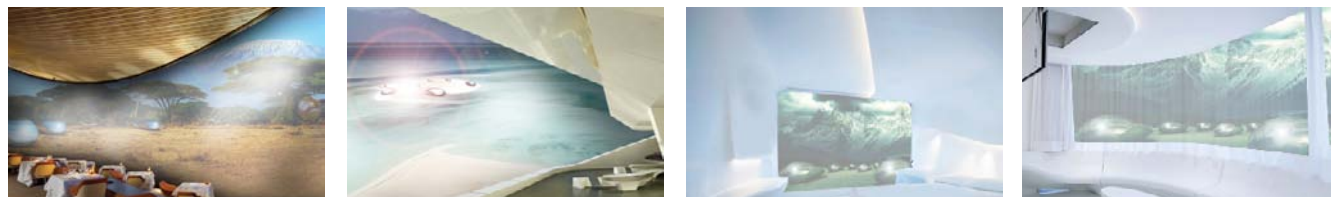

Credits

Graphic design

Marta Stanislawczyk | Agency Artediem | Tel: +48 508.123.773

marta.stanislawczyk@axelspringer.pl

Al Reymonta, 28/3 - 01-842 Warsaw

Poland

Photos

Dreamstime.com ©: Galyna Andrushko, Plotnikov, Ben Goode, Matthew Connolly, Stephan Pietzko, Steve Allen,

Paul Hampton | © Marta Stanislawczyk

Contact

Concept & Project

Raphael Delstanche | R&D - Mediance Hotel | Tel: +48 607.498.261

rdelstanche@gmail.com

Al Reymonta, 28/3 - 01-842 Warsaw

Poland